

CLASS 150 FLANGES

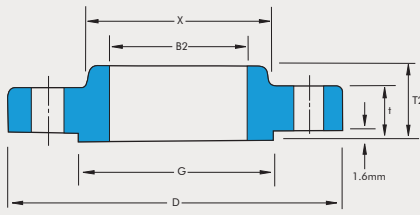

SLIP-ON

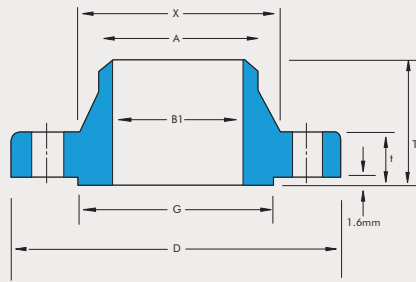

WELDING NECK

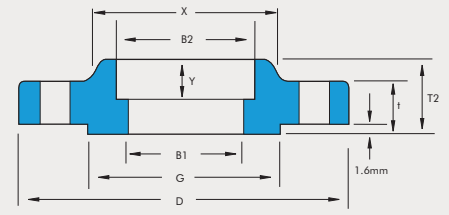

SOCKET WELDING

ANSI B16.5 FORGED FLANGES

Unit:mm

Nominal Pipe Size	Outside Dia.	Dia. at Base of Hub	O.D. of Raised Face	Thick- ness t	BORE			LENGTH THRU HUB			Dia. Of Hub at Bevel	Radius of Fillet	Thread Length
					Welding Neck Socket Welding	Slip-on Socket Welding	Lap Joint	Welding Neck	Slip on Threaded Socket Welding	Lap Joint			
	D	X	G		B1	B2	B3	T1	T2	T3	A	R	Q
1/2	89.0	30.2	35.1	11.2	15.7	22.4	22.9	47.8	15.7	15.7	21.3	3.0	15.7
3/4	99.0	38.1	42.9	12.7	20.8	27.7	28.2	52.3	15.7	15.7	26.7	3.0	15.7
1	108.0	49.3	50.8	14.2	26.7	34.5	35.1	55.6	17.5	17.5	33.5	3.0	17.5
1 1/4	117.0	58.7	63.5	15.7	35.1	43.2	43.7	57.2	20.6	20.6	42.2	4.8	20.6
1 1/2	127.0	65.0	73.2	17.5	40.9	49.5	50.0	62.0	22.4	22.4	48.3	6.4	22.4
2	152.0	77.7	91.9	19.1	52.6	62.0	62.5	63.5	25.4	25.4	60.5	7.9	25.4
2 1/2	178.0	90.4	104.6	22.4	62.7	74.7	75.4	69.9	28.4	28.4	73.2	7.9	28.4
3	191.0	108.0	127.0	23.9	78.0	90.7	91.4	69.9	30.2	30.2	88.9	9.7	30.2
3 1/2	216.0	122.2	139.7	23.9	90.2	103.4	104.1	71.4	31.8	31.8	101.6	9.7	31.8
4	229.0	134.9	157.2	23.9	102.4	116.1	116.8	76.2	33.3	33.3	114.3	11.2	33.3
5	254.0	163.6	185.7	23.9	128.3	143.8	144.5	88.9	36.6	36.6	141.2	11.2	36.6
6	279.0	192.0	215.9	25.4	154.2	170.7	171.5	88.9	39.6	39.6	168.4	12.7	39.6
8	343.0	246.1	269.7	28.4	202.7	221.5	222.3	101.6	44.5	44.5	219.2	12.7	44.5
10	406.0	304.8	323.9	30.2	254.5	276.4	277.4	101.6	49.3	49.3	273.1	12.7	49.3
12	483.0	365.3	381.0	31.8	304.8	327.2	328.2	114.3	55.6	55.6	323.9	12.7	55.6
14	533.0	400.1	412.8	35.1	336.6	359.2	360.2	127.0	57.2	79.2	355.6	12.7	57.2
16	597.0	457.2	469.9	36.6	387.4	410.5	411.2	127.0	63.5	87.4	406.4	12.7	63.5
18	635.0	505.0	533.4	39.6	438.2	461.8	462.3	139.7	68.3	96.8	457.2	12.7	68.3
20	699.0	558.8	584.2	42.9	489.0	513.1	514.4	144.5	73.2	103.1	508.0	12.7	73.2
24	813.0	663.4	692.2	47.8	590.6	616.0	616.0	152.4	82.6	111.3	609.0	12.7	82.6

Note : (1) For the 'Bore' (B1) other than standard Wall Thickness, refer to page.

(2) Class 150 flanges except Lap Joint will be furnished with 0.06" (1.6 mm) raised face, which is included in 'Thickness' (t) and 'Length through Hub' (T₁), (T₂).

(3) For Slip-on, Threaded, Socket Welding and Lap Joint Flanges, the hubs can be shaped either vertical from base to top or tapered within the limits of 7 degrees.

CLASS 150 FLANGES

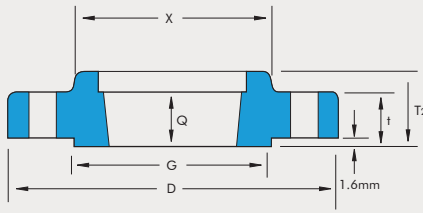

THREADED

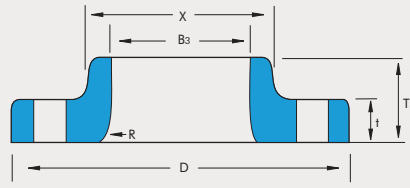

LAP JOINT

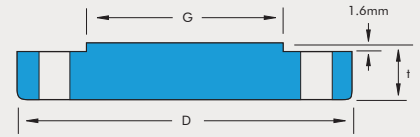

BLIND

Unit:mm

Number	Depth	DRILLING			BOLTING				APPROXIMATE WEIGHT										
		Bolt	Number	Dia.	Dia.	Machine	Stud Bolt			Welding		Slip - on		Lop		Blind		Socket	
Pipe	of	Circle	of	of	of	Bolt	Length	Raised	Ring	Neck	and		Joint				Welding		
Size	Socket	Dia.	Holes	Holes	Bolts	Length	Face	Joint			Threaded								
	Y				(inch)	Face				Kg.	lb	Kg.	lb	Kg.	lb	Kg.	lb	Kg.	lb
1/2	9.7	60.5	4	15.7	1/2	50.8	57.2	--		0.51	1.10	0.47	1.00	0.51	1.00	0.47	1.00	0.47	1.00
3/4	11.2	69.9	4	15.7	1/2	50.8	63.5	--		0.73	1.60	0.58	1.30	0.64	1.40	0.63	1.40	0.59	1.30
1	12.7	79.2	4	15.7	1/2	57.2	63.5	76.2		1.07	2.40	0.86	1.90	0.93	1.80	0.94	2.10	0.87	1.90
1 1/4	14.2	88.9	4	15.7	1/2	57.2	69.9	82.6		1.40	3.10	1.08	2.40	1.16	2.00	1.23	2.70	1.11	2.40
1 1/2	15.7	98.6	4	15.7	1/2	63.5	69.9	82.6		1.81	4.00	1.41	3.10	1.51	3.30	1.62	3.60	1.45	3.20
2	17.5	120.7	4	19.1	5/8	69.9	82.6	95.3		2.59	5.70	2.26	5.00	2.38	5.20	2.64	5.80	2.33	5.00
2 1/2	19.1	139.7	4	19.1	5/8	76.2	88.9	101.6		4.28	9.40	3.43	7.60	3.60	7.90	4.06	9.00	3.55	7.80
3	20.6	152.4	4	19.1	5/8	76.2	88.9	101.6		5.18	11.40	3.87	8.50	4.04	8.90	4.90	10.80	4.02	8.90
3 1/2	22.4	177.8	8	19.1	5/8	76.2	88.9	101.6		5.45	12.00	4.99	11.00	4.99	11.00	5.90	13.00	4.99	11.00
4	23.9	190.5	8	19.1	5/8	76.2	88.9	101.6		7.32	16.10	5.75	12.70	5.96	13.00	7.41	16.30	5.99	13.20
5	23.9	215.9	8	22.4	3/4	82.6	95.3	108.0		8.91	19.60	6.22	13.70	6.44	14.00	8.76	19.30	6.68	14.70
6	26.9	241.3	8	22.4	3/4	82.6	101.6	114.3		11.26	24.80	7.38	16.30	7.59	16.70	11.31	24.90	7.99	17.60
8	31.8	298.5	8	22.4	3/4	88.9	108.0	120.7		17.68	39.00	12.36	27.30	12.66	27.90	19.92	43.90	13.29	29.30
10	33.3	362.0	12	25.4	7/8	101.6	114.3	127.0		24.79	54.70	17.10	37.70	16.78	37.00	29.39	64.80	19.50	43.00
12	39.6	431.8	12	25.4	7/8	101.6	120.7	133.4		38.98	85.90	27.68	61.00	28.30	62.40	43.70	96.30	29.03	64.00
14	41.4	476.3	12	28.4	1.0	114.3	133.4	146.1		51.71	114.00	35.20	77.60	41.50	91.50	59.42	140.00	38.56	85.00
16	44.5	539.8	16	28.4	1.0	114.3	133.4	146.1		64.41	142.00	42.18	93.00	52.98	116.80	77.11	170.00	44.49	98.00
18	49.3	577.9	16	31.8	1.1/8	127.0	164.1	158.1		74.84	165.00	49.71	109.60	59.00	130.00	94.80	209.00	54.43	120.00
20	54.1	635.0	20	31.8	1.1/8	139.7	158.8	171.5		89.36	197.00	65.50	140.00	72.12	159.00	123.38	272.00	70.31	155.00
24	63.5	749.3	20	35.1	1.1/4	152.4	171.5	184.2		119.66	263.80	90.50	199.50	99.02	218.30	188.24	415.00	95.25	210.00

- Note :** (4) Blind Flanges may be made with the same hub as that used for Slip-on Flanges or without hub.
- (5) The gasket surface and backside (bearing surface for bolting) are made parallel within 1 degree. To accomplish parallelism, spot facing is carried out according to MSS SP-9, without reducing thickness(t).
- (6) Depth of Socket (Y) is covered by ANSI B16.5 only in sizes through 3 inch, over 3 inch is at the manufacturer's option.

